

EVpack-fuse MEV70

700 VDC Max., L/R ≤ 1ms, 35 - 600A

BATTERY FUSES

BATTERY PACK FUSES



EVpack-fuse line-up belongs to the new DC Over-Current protection (O.C.P.) range developed by MERSEN to address specific needs in EV/HEV and Battery Electrical Storage System

EVpack-fuse provides the ultimate protection of the battery pack offering reliable clearing of DC fault currents.

It has been specifically engineered and tested to provide DC applications best-in-class protection performance: Up to 700VDC, Current rating (In)= 35 to 600A, Interrupting Rating (IR) = 20kA, L/R ≤ 1ms, Minimum Breaking Capacity (MBC) < 3kA for a perfect matching with DC contactor in addition to withstanding high inrush current auxiliary applications (e.g. air conditioning...) with MEV70V.

Typical usage of EVpack-fuse in Mersen DC protection family

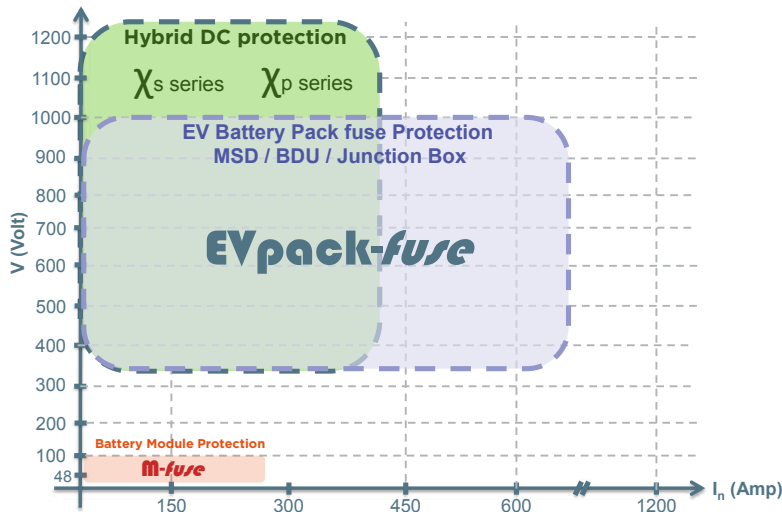

FEATURES & BENEFITS

- Design for DC applications
- Low watt losses
- High cycling performance
- Full coverage of battery module voltage and current
- Ultra compact size
- Current Ratings (In): 35 to 600A
- Interrupting Rating (IR): 20kA @ 700VDC, L/R ≤ 1ms
- High inrush current capability

APPLICATIONS

- EV/HEV
- Electrical Energy Storage
- Battery pack protection
- Battery Disconnect Unit (BDU)
- Battery Junction Box for auxiliaries
- Battery charger
- Supercapacitor pack protection
- Backup protection for DC relay / disconnect / switch
- Maintenance Safety Disconnect (MSD)

STANDARDS

- Power Cycling & Vibration: JASO D622



EV pack-fuse

PRODUCT RANGE



MEV70V100-S

MEV70V -S Surface Mount Fuse

Catalog number	Rated DC voltage	Rated current I _n	Power dissipation at 0.5 I _n	Min. breaking capacity (MBC)	Max. time to clear MBC	Weight
MEV70V35-S	700 V	35 A	0.86 W	125 A	5 s	9.9 g
MEV70V40-S	700 V	40 A	0.82 W	150 A	5 s	9.9 g
MEV70V50-S	700 V	50 A	1.2 W	175 A	5 s	9.9 g
MEV70V60-S	700 V	60 A	1.47 W	200 A	5 s	9.9 g
MEV70V70-S	700 V	70 A	1.89 W	200 A	30 s	59 g
MEV70V80-S	700 V	80 A	1.75 W	270 A	30 s	59 g
MEV70V100-S	700 V	100 A	2 W	330 A	30 s	59 g
MEV70V125-S	700 V	125 A	2.74 W	1500 A	150 ms	59 g
MEV70V150-S	700 V	150 A	3.54 W	1500 A	200 ms	59 g
MEV70V160-S	700 V	160 A	3.75 W	1500 A	300 ms	59 g
MEV70V175-S	700 V	175 A	4.63 W	1500 A	420 ms	59 g



MEV70A600-4

MEV70A Round Body Fuse

Catalog number	Rated DC voltage	Rated current I _n	Power dissipation at 0.5 I _n	Min. breaking capacity (MBC)	Max. time to clear MBC	Weight
MEV70A50-4	700 V	50 A	1.4 W	380 A	50 ms	99 g
MEV70A60-4	700 V	60 A	1.8 W	460 A	50 ms	99 g
MEV70A70-4	700 V	70 A	2.2 W	540 A	50 ms	99 g
MEV70A80-4	700 V	80 A	2.5 W	610 A	50 ms	99 g
MEV70A90-4	700 V	90 A	2.7 W	690 A	50 ms	99 g
MEV70A100-4	700 V	100 A	3.1 W	760 A	50 ms	99 g
MEV70A125-4	700 V	125 A	3.8 W	870 A	60 ms	165 g
MEV70A150-4	700 V	150 A	4.5 W	1040 A	60 ms	165 g
MEV70A175-4	700 V	175 A	5.2 W	1210 A	60 ms	165 g
MEV70A200-4	700 V	200 A	5.9 W	1380 A	60 ms	165 g
MEV70A225-4	700 V	225 A	6.7 W	1190 A	140 ms	260 g
MEV70A250-4	700 V	250 A	7.4 W	1320 A	140 ms	260 g
MEV70A300-4	700 V	300 A	8.8 W	1580 A	140 ms	260 g
MEV70A350-4	700 V	350 A	10.2 W	1840 A	140 ms	260 g
MEV70A400-4	700 V	400 A	11.7 W	2100 A	140 ms	260 g
MEV70A450-4	700 V	450 A	12.4 W	2200 A	360 ms	517 g
MEV70A500-4	700 V	500 A	13.9 W	2460 A	360 ms	517 g
MEV70A600-4	700 V	600 A	16.6 W	2950 A	360 ms	517 g

TIME CURRENT CHARACTERISTIC CURVES

MEV70V-S

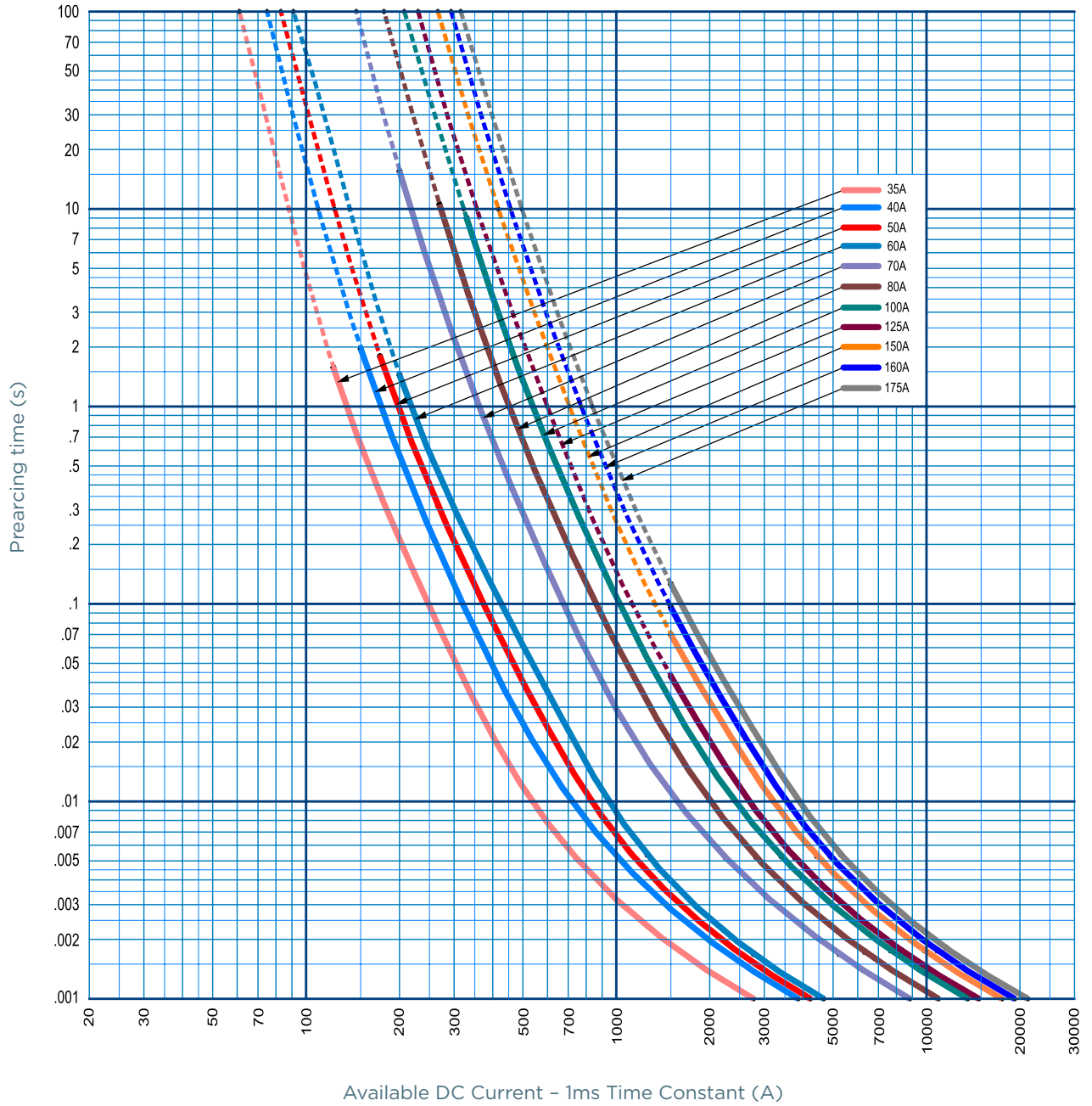

MERSEN reserves the right to change, update or correct, without notice, any information contained in this datasheet.

TIME CURRENT CHARACTERISTIC CURVES

MEV70A

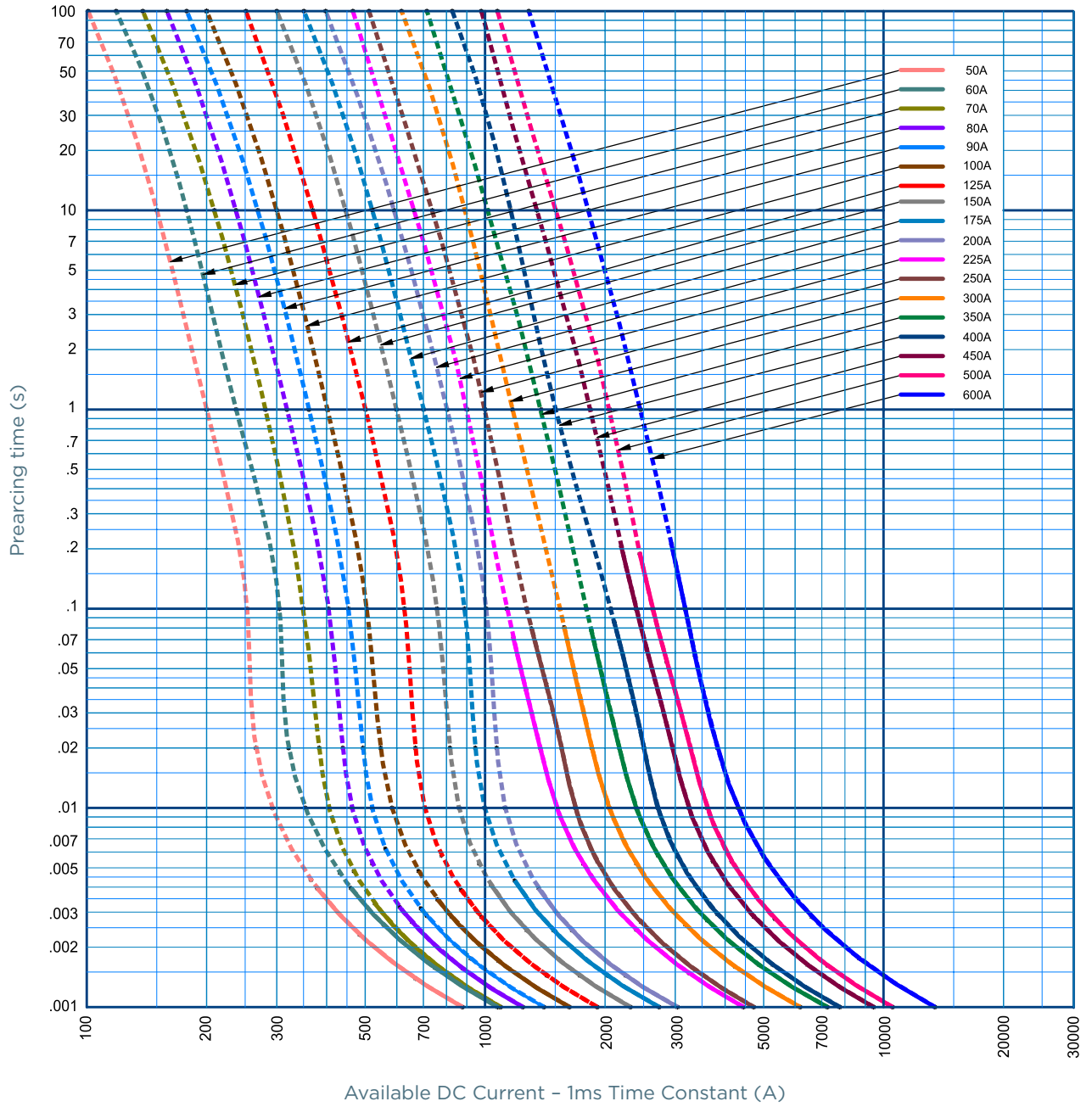

MERSEN reserves the right to change, update or correct, without notice, any information contained in this datasheet.

POWER DISSIPATION

MEV70V-S

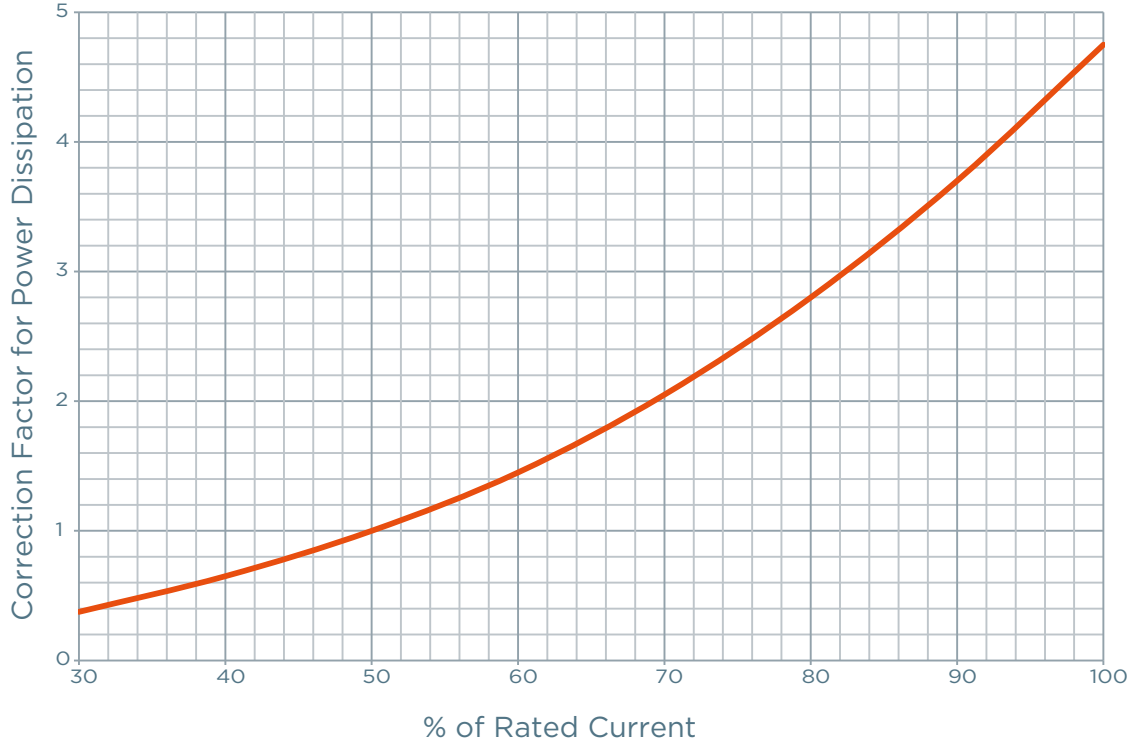

MEV70A

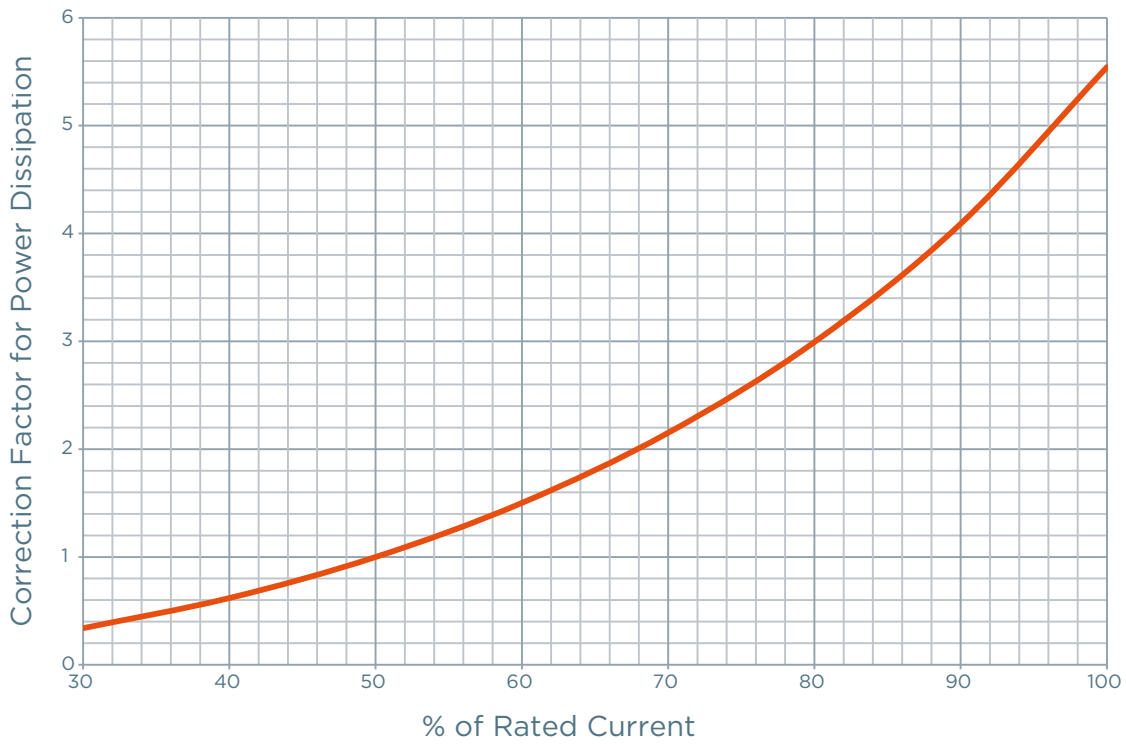

MERSEN reserves the right to change, update or correct, without notice, any information contained in this datasheet.

TEMPERATURE DERATING

MEV70V-S & MEV70A

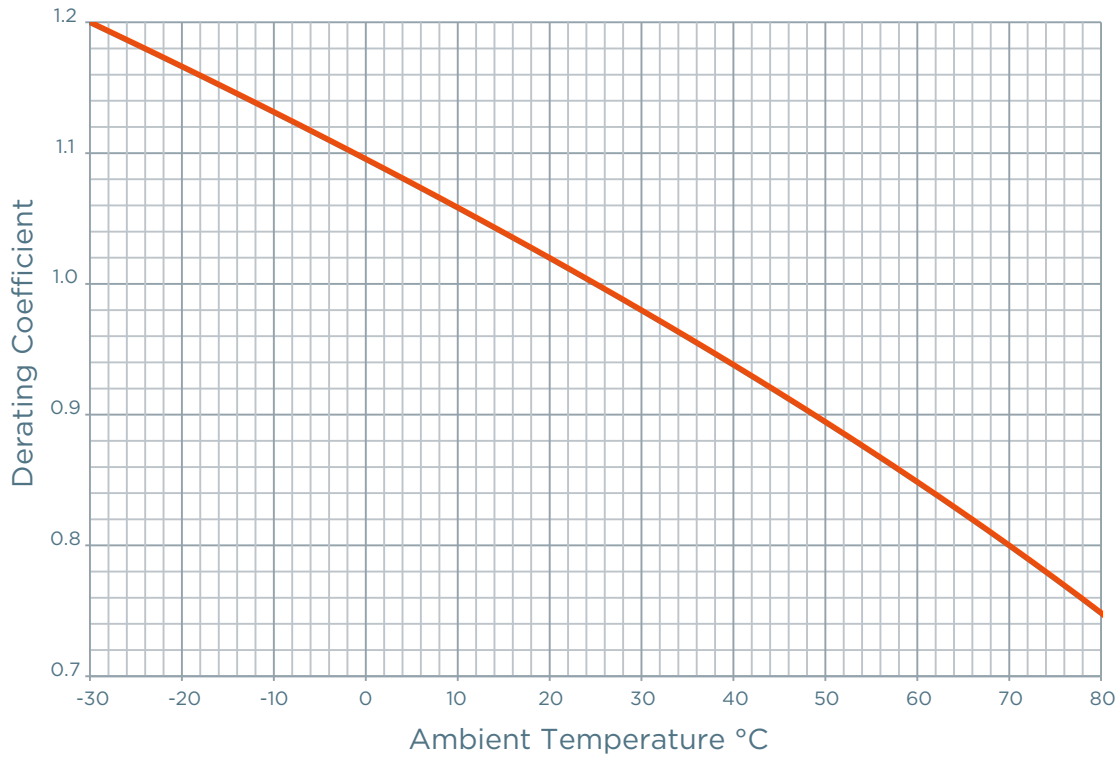

DIMENSIONS

MEV70V -S (35-60A)

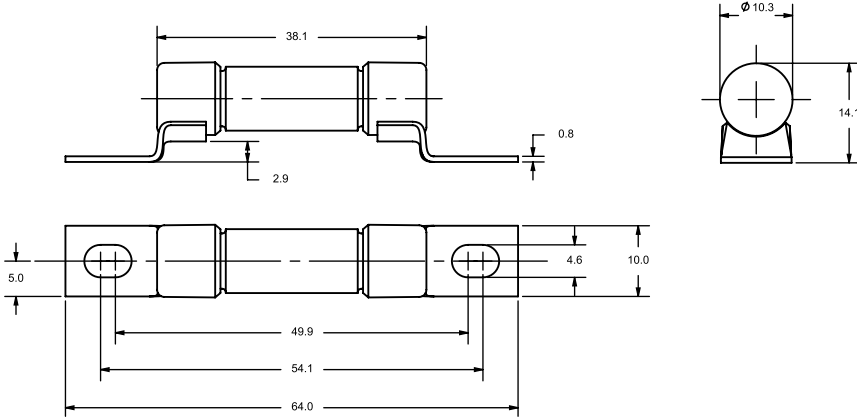

Dimensions in mm

MEV70V -S (70-175A)

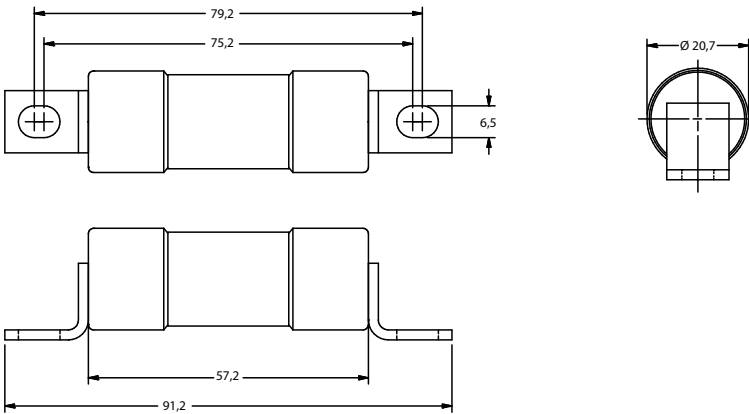

Dimensions in mm

MEV70A -4 (50-600A)

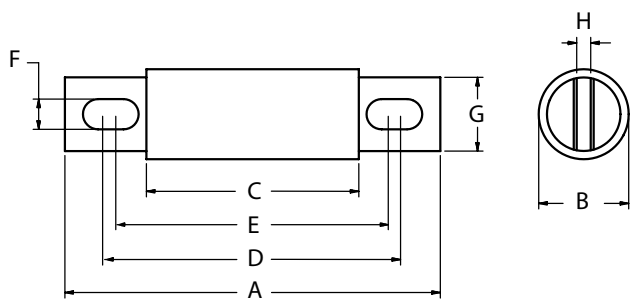

Article Number	A	B	C	D	E	F	G	H
MEV70A50 to 100 (inch. / mm)	3,63 92,2	1 25,4	2,13 54,1	2,94 74,7	2,75 69,85	0,31 7,9	0,5 19	0,13 3,2
MEV70A125 to 200 (inch. / mm)	3,63 92,2	1,22 31	2,13 54,1	2,94 74,7	2,81 71,4	0,31 7,9	1 25,4	0,19 4,8
MEV70A225 to 400 (inch. / mm)	4,34 110	1,5 38,1	2,09 53,1	3,41 86,6	2,78 70,6	0,41 10,4	1 25,4	0,25 6,4
MEV70A450 to 600 (inch. / mm)	4,47 114	2 50,8	2,22 56,4	3,53 89,7	2,91 73,9	0,41 10,4	1,5 38,1	0,25 6,4